

# DIN NH-TYPE FUSES SIZE 4 / 4a (500V & 690V)



500VAC gG		
Part Number	Ampere Rating	Body Size
4-NB630	630A	4
4-NB800	800A	4
4-NB1000	1000A	4
4-NB1250	1250A	4

4A-NB630	630A	4a
4A-NB800	800A	4a
4A-NB1000	1000A	4a
4A-NB1250	1250A	4a
4A-NB1500	1500A	4a
4A-NB1600	1600A	4a

690VAC gG		
Part Number	Ampere Rating	Body Size
4-GG630	630	4
4-GG800	800	4
-	1000A	-
-	1250A	-

4A-GG630	630A	4a
4A-GG800	800A	4a
4A-GG1000	1000A	4a
4A-GG1250	1250A	4a

500VAC aM		
Part Number	Ampere Rating	Body Size
4-SB630	630	4
4-SB800	800	4
4-SB1000	1000	4
4-SB1250	1250	4

4A-SB630	630A	4a
4A-SB800	800A	4a
4A-SB1000	1000A	4a
4A-SB1250	1250A	4a

**I.R. 500V:** 120kA at 500VAC (Type gG/gL/aM).

**I.R. 690V:** 100kA at 690VAC (Type gG/gL).

**Voltage:** VAC as rated.

**Voltage:** VDC call for confirmation.

**Pack Size (box):** 3.

**Holders:** Bases (p139)

Disconnect Switches (contact sales).

**Accessories:** NH-Extractor (p150)

**Notes:** \* Ratings also available in compact body.

**Approvals:** IEC60269, DIN 43620, VDE 0636

**Notes:** gL (general application-normal acting).  
aM (motor start-delayed action).

**Note:** Size 4 has open slotted blades for bolted fixing (16mm x 32mm).

**Features:** 'Flag' indicator located on top plate of fuse is standard.



**Size 4  
Slotted Blade**



**Size 4a  
Full Blade**

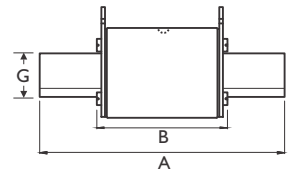
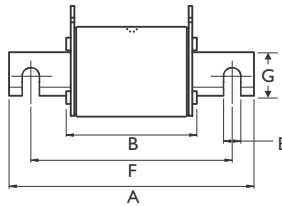
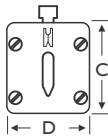

Dimensions in MM

Size	Tag Type	A	B	C	D	E	F	G
4	Slotted	200	75	121	100	16	150	50
4a	Full Blade	200	99	121	95	-	-	50

## NH SOLID LINKS - NON INSULATED



Part Number	Ampere Rating	Size	Tag	Dimensions in MM			
				A	B	C	D
00-NTRL	160A	00	Blade	78.5	50	15	45
1-NTRL	250A	1	Blade	135	68	20	50
2-NTRL	400A	2	Blade	150	68	26	58
3-NTRL	630A	3	Blade	150	68	32	70



**Voltage:** 690VAC

**Pack Size (box):** 1

**Options:** Insulated version also available upon request.

**Accessories:** NH-Extractor (p150)

**Note:** Neutral links can be used in a fuse base if circuit protection is NOT required.

