

FF SERIES

SIZE C2 (TTM / R11)

Bussmann Part Number	Redspot (415V) Part Number	Ampere Rating	Voltage (VAC)	Voltage (VDC)	Type
FF450	TTM450L	450A	550V	400V	gG
FF500	TTM500L	500A	550V	400V	gG
FF560	TTM560L	560A	550V	400V	gG
FF630	TTM630L	630A	550V	400V	gG

FF / GF Specifications

I.R.: 80kA at rated VAC
Voltage: VAC (As listed)
 VDC (As listed)

Characteristic: See Type Listing
Pack Size (box): 1

Notes: 660V versions also available contact sales for further information.

Approvals: BS88, IEC269-1

GF SERIES

SIZE C3 (TLM)

Bussmann Part Number	Redspot (415V) Part Number	Ampere Rating	Voltage (VAC)	Voltage (VDC)	Type
-	TLM670	670A	660V	TBC	gG
GF710	TLM710L	710A	550V	250V	gG
-	TLM750	750A	660V	TBC	gG
GF800	TLM800L	800A	550V	250V	gG

FF / GF



FG SERIES

(TT)

Bussmann Part Number	Redspot (660V) Part Number	Ampere Rating	Voltage (VAC)	Voltage (VDC)	Type
FG450	TT450	450A	550V	400V	gG
FG500	TT500	500A	550V	400V	gG
FG560	TT560	560A	550V	400V	gG
FG630	TT630	630A	550V	400V	gG

FG / GG Specifications

I.R.: 80kA at rated VAC
Voltage: VAC (As listed)
 VDC (As listed)

Characteristic: See Type Listing
Pack Size (box): 1

Notes: 660V versions also available contact sales for further information.

Approvals: BS88, IEC269-1

GG SERIES

(TLT)

Bussmann Part Number	Redspot (415V) Part Number	Ampere Rating	Voltage (VAC)	Voltage (VDC)	Type
GG710	TLT710	710A	550V	250	gG
GG800	TLT800	800A	550V	250	gG
GG1000	-	1000A	550V	-	gG
GG1250	-	1250A	550V	-	gG

FG / GG

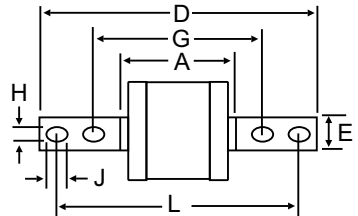
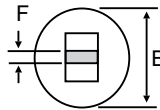

Dimensions in MM

Fuse	Ampere Rating	A	B	D	E	F	G	H	J	L
FF	450A - 630A	77.5	74	210	25.4	6.4	134	10.5	15.5	185
GF	710A - 800A	80.5	83	210	25.4	9.5	134	10.5	15.5	185
FG	450A - 630A	77.5	74	262	38	6.4	167	10.5	15.5	231
GG	710A - 800A	77.5	83	262	38	6.4	167	10.5	6.4	231
GG	1000A - 1250A	84.0	100	262	38	12.7	165	10.5	12.7	228.5