

# ULTRA MICRO 280 RELAYS - 303 SERIES



Part Number	Voltage	Contact Action	Ampere Rating		Terminals	Protection
			N/O	N/C		
3031AHCR112	12V	SPST	20A	-	4 x 2.8mm	½W 1.1KΩ resistor
3031AHCR124	24V	SPST	10A	-	4 x 2.8mm	½W 4.3KΩ resistor

**Contact Rating (Motor /Lamp) N/O:** 16A (14VDC), In-rush 80A

**Coil Current:** 80mA (12V), 40mA (24V)

**Coil Resistance:** 150Ω (12V), 600Ω (24V)

**Contact Voltage Drop:** Typ. 50mV at 10A

**Contact Material:** Silver Tin Oxide alloy (AgSnO)

**Operate / Release Time:** 10ms max. / 10ms max.

**Enclosure:** flux tight seal.

**Temperature:** -40 to +125°C (no freezing)

**Mechanical Life Expectancy:** 10 million operations.

**Pack Size:** 1pc, 10pcs, 100pcs, 500pcs.

**Options:** Sealed washable enclosure. Diode protection.

**Suits Power Distribution Modules:** Pages 120 - 128, 138-144.

**Approval:** ELV-2000/53/EC RoHS



**Terminal Size**  
□ 2.8mm

### 3031AHCR1 series

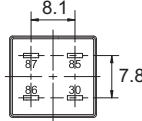
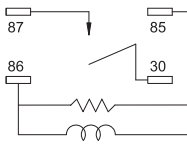

Dimensions in MM

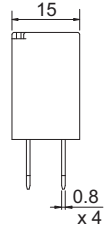
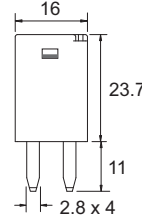

# MICRO 280 RELAYS - 301 SERIES



Part Number	Voltage	Contact Action	Ampere Rating		Terminals	Protection
			N/O	N/C		
3011ACR112	12V	SPST	35A	-	4 x 2.8mm	½W 680Ω resistor
3011CCR112	12V	SPDT	35A	20A	5 x 2.8mm	½W 680Ω resistor
3011ACR124	24V	SPST	15A	-	4 x 2.8mm	½W 2700Ω resistor
3011CCR124	24V	SPDT	15A	10A	5 x 2.8mm	½W 2700Ω resistor

**Coil Current:** 97.5mA (12V), 49.6mA (24V)

**Coil Resistance:** 123Ω (12V), 483Ω (24V)

**Contact Voltage Drop:** Typ. 40mV at 10A

**Contact Material:** Silver Tin Oxide alloy (AgSnO)

**Operate / Release Time:** 10ms max. / 10ms max.

**Enclosure:** flux tight seal.

**Temperature:** -40 to +125°C (no freezing)

**Mechanical Life Expectancy:** 10 million operations.

**Pack Size:** 1pc, 10pcs, 100pcs, 500pcs.

**Options:** Sealed washable / Dust cover enclosure. Diode protection.

**Suits Power Distribution Modules:** Pages 120 - 135, 138-146.

**Approval:** ELV-200/53/EC RoHS

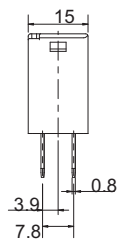
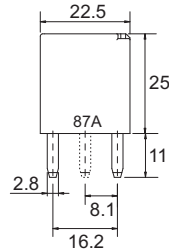

Dimensions in MM

**Terminal Size**  
□ 2.8mm

### 3011ACR1 series

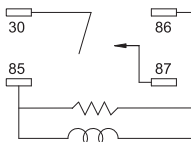

### 3011CCR1 series

