

# CIRCUIT BREAKERS - SERIES 19 WIDE MOUNT BRACKET



## Features:

- Wide range of ratings from 25A to 200A.
- Superior Ingress Protection, rated to IP67 & IP69K.
- Designed for harsh applications to 30VDC.
- Optional LED tripID version for open circuits.
- Wide bracket version available in natural or black.
- Circuit breaker made in USA. Subassembly made in Australia.

### Manual Reset TIII Natural Bracket

Part Number	Part Number	Ampere Rating
I9M-P21-B-175	I9A-P21-N-175	175A
I9M-P21-B-200	I9A-P21-N-200	200A

### Auto Reset TI Natural Bracket

**Voltage:** 30VDC

**I.R. (25A - 150A):** 2.5kA at 14VDC, 1.5kA at 28VDC. Made to order.

**I.R. (175A - 200A):** 2.5kA at 30VDC, Standard product.

**Auto Reset Standard Model:** No indicator.

**Auto Reset Optional Model:** Red or Clear LED indicator.

**Manual Reset Standard Model:** Red Button.

**Manual Reset Optional Model:** Red or Clear LED indicating button.

All manual reset buttons feature a white ampere marking.

**Mounting Plate:** Natural finish standard. Black powder coat optional.

Includes 4 x # 10-32 x 1/2" stainless steel philips head screws.

**Termination:** 1/4"-28 (12.5mm long) stainless steel studs.

Includes stainless steel sems nuts.

**Housing:** UL 94-V0 rated black thermoplastic.

**Operating Temp:** -40 degrees C. to 85 degrees C.

**Pack Size:** 1pc stock lines (36pcs non stock lines).

**Approvals:** SAE J1625, SAE J1171, ABYC E-11, UL1077,

Mil-STD-202 (101, 106, 213), Mil-STD-204.

**Notes:** Contact sales for details on all custom made product options.



**I9M-P21-B-xxx  
Manual Reset TIII**

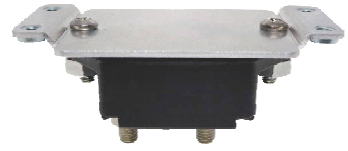

**I9A-P21-N-xxx  
Automatic Reset TI**

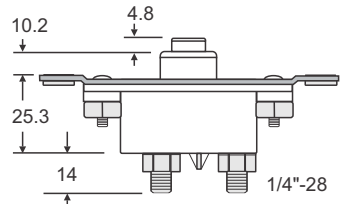

### Rear View

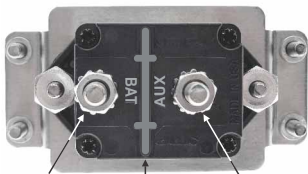

4 Mounting Screws  
#10-32 x 1/2"  
SS Phillips Head  
included

Battery 1/4"-28 Input Stud      Stud Barrier      Auxiliary 1/4"-28 Output Stud

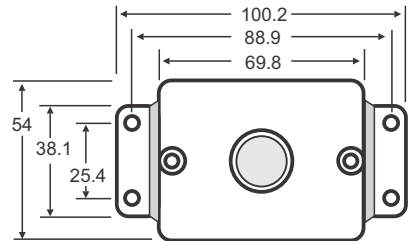

Dimensions in MM

## CUSTOM MADE OPTIONS



**I9M-P21-B-xxxB  
Manual Reset TIII  
With Black Bracket**



**I9A-P21-R-xxx  
Automatic Reset TI  
With LED TripID™ Feature**



**I9M-P21-R-xxx  
Manual Reset TIII  
With LED TripID™ Feature**



Email: [info@prolegproducts.com.au](mailto:info@prolegproducts.com.au)  
Web: [www.prolegproducts.com.au](http://www.prolegproducts.com.au)