

Features:

- Wide range of ratings from 25A to 200A.
- Smallest breaker in range for 175A & 200A Ratings.
- Superior Ingress Protection, rated to IP67 & IP69K.
- Designed for harsh applications to 30VDC.
- Optional LED triplD version for open circuits.
- Front panel or rear panel mounting options.
- Trip free.
- Wide bracket version available in natural or black.
- Made in USA. Some subassembly made in Australia.



MIL-STD

IP69K

IGNITION PROTECTED

NEW



19M-P10 Series, Manual Reset TIII
Thru Hole, No Nuts



19M-P11 Series, Manual Reset TIII
#10-32 Mounting Nut



19A-P10 Series, Automatic Reset TI
Non Indicating

Auto Reset (Thru Hole) Part Number	Manual Reset (Thru Hole) Part Number	Manual Reset (Mounting Nut) Part Number	Ampere Rating
19A-P10-N-025	19M-P10-B-025	19M-P11-B-025	25A
19A-P10-N-030	19M-P10-B-030	19M-P11-B-030	30A
19A-P10-N-035	19M-P10-B-035	19M-P11-B-035	35A
19A-P10-N-040	19M-P10-B-040	19M-P11-B-040	40A
19A-P10-N-045	19M-P10-B-045	19M-P11-B-045	45A
19A-P10-N-050	19M-P10-B-050	19M-P11-B-050	50A
19A-P10-N-060	19M-P10-B-060	19M-P11-B-060	60A
19A-P10-N-070	19M-P10-B-070	19M-P11-B-070	70A
19A-P10-N-080	19M-P10-B-080	19M-P11-B-080	80A
19A-P10-N-090	19M-P10-B-090	19M-P11-B-090	90A
19A-P10-N-100	19M-P10-B-100	19M-P11-B-100	100A
19A-P10-N-105	19M-P10-B-105	19M-P11-B-105	105A
19A-P10-N-120	19M-P10-B-120	19M-P11-B-120	120A
19A-P10-N-135	19M-P10-B-135	19M-P11-B-135	135A
19A-P10-N-150	19M-P10-B-150	19M-P11-B-150	150A
19A-P10-N-175	19M-P10-B-175	19M-P11-B-175	175A
19A-P10-N-200	19M-P10-B-200	19M-P11-B-200	200A

Voltage: 30VDC

I.R. (25A - 150A): 2.5kA at 14VDC, 1.5kA at 28VDC

I.R. (175A - 200A): 2.5kA at 30VDC

Auto Reset Stocked Version: No indicator.

Auto Reset Indent Options: Red LED or Clear LED Indicator.

Manual Reset Stocked Version: Red Button.

Manual Reset Indent Options: Red LED or Clear LED Button.

All manual reset buttons feature a white ampere marking.

Panel Mounting Hardware Options:

- Thru-hole, no nuts (19x-P10)
- 2 x # 10-32 fitted nuts (19x-P11)

Threaded Studs: 1/4"-28 (12.5mm long), includes 1/4" stainless steel sems nuts.

Housing: UL 94-V0 rated black thermoplastic.

Operating Temp: -40 deg. C to 85 deg. C

Pack Size: 1pc stock lines (9pcs non stock lines).

Approvals: SAE J1625, SAE J1171, ABYC E-11, UL1077, Mil-STD-202 (101, 106, 213), Mil-STD-204.

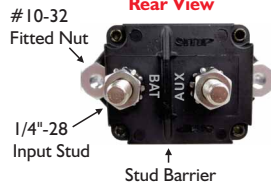

Optional Feature
TriplD, LED Indicating Button.



Normal Operation Unlit



Open Circuit LED Lit

19M-P10 / P11 Series

Standard Mounting Bracket

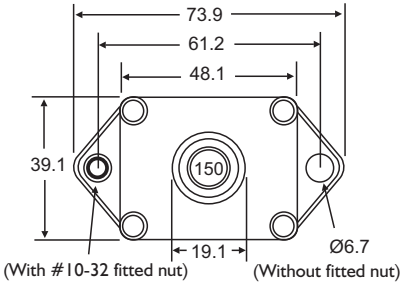

Rear Mount Panel Cut-out

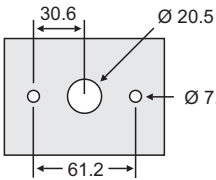

Front Mount Panel Cut-out

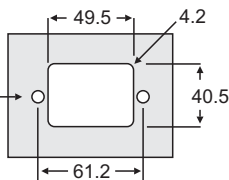

Dimensions in MM