

Part Number	Ampere Rating	Total I <sup>2</sup> t at 500V
FWH-35B	35A	150
FWH-40B	40A	320
FWH-45B	45A	450
FWH-50B	50A	670
FWH-60B	60A	900
FWH-70B	70A	900
FWH-80B	80A	1 400
FWH-90B	90A	1 600
FWH-100B	100A	2 000
FWH-125B	125A	3 500
FWH-150B	150A	4 600
FWH-175B	175A	6 200
FWH-200B	200A	8 500
FWH-225A	225A	23 300
FWH-250A	250A	32 200
FWH-275A	275A	40 300
FWH-300A	300A	49 800
FWH-325A	325A	63 800
FWH-350A	350A	72 900
FWH-400A	400A	96 700
FWH-450A	450A	127 000
FWH-500A	500A	149 000
FWH-600A	600A	206 000
FWH-700A	700A	298 000
FWH-800A	800A	409 000
FWH-900A	900A	363 500
FWH-1000B	1000A	450 000
FWH-1200B	1200A	600 000
FWH-1400A	1400A	1 000 000
FWH-1600A	1600A	1 400 000

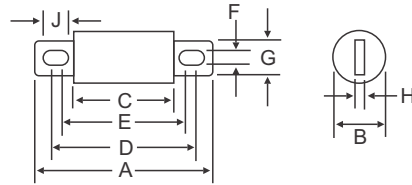

**Diagram 1**  
(35A - 1200A)



I.R.: 200kA at 500VAC (all ratings)  
50kA at 500VDC (35A to 800A)

Voltage: 500VAC (all ratings)  
500VDC (35A to 800A)\*

Characteristic: Type aR, Very Fast Acting

Pack Size: Varies

Holders (35A to 1200A): Blocks (p.135-136)

Notes: For information on ferrule cartridge fuses (ratings 1A - 30A) please contact sales.

Approvals: CE (35A to 1600A)

UL (35A to 600A,  
1000A to 1200A)

**RELATED PRODUCTS:**

**Modular Fuse Blocks**  
(see p.135-136)



**Diagram 2**  
(1400A - 1600A)

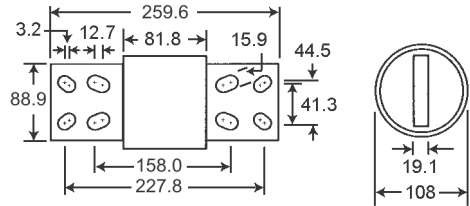

Dimensions in MM

Ampere Rating	Diagram	A	B	C	D	E	F	G	H	J	
35A to 60A	1	81.0	20.7	40.5	64.5	55.7	8.7	18.3	3.2	13.2	
70A to 100A	1	92.1	24.1	44.1	72.5	71.3	8.9	19.1	3.2	9.5	
125A to 200A	1	92.1	29.4	46.6	73.5	70.3	8.7	25.4	4.8	10.3	
225A to 400A	1	110.2	38.1	53.1	87.4	69.9	10.4	25.4	6.4	19.1	
450A to 600A	1	110.2	50.8	53.1	89.7	70.6	10.4	38.1	6.4	19.8	
700A to 800A	1	161.0	63.5	53.1	126.2	87.4	13.5	50.8	9.7	33.0	
900A to 1200A	1	177.0	76.2	81.8	138.8	113.7	15.9	60.3	11.1	28.4	
1400A to 1600A	2	See dimensions in 'Diagram 2' schematic box									