

# JAPANESE SEMICONDUCTOR FUSES 250V

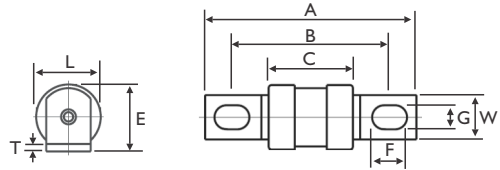

Hinode Part Number	Kyosan Code	Fuji Code	Ampere Rating
250GG-75	25SH75	CR2L-75	75A
250GG-100	25SH100	CR2L-100	100A
250GG-110	25SH110	-	110A
250GG-125	25SH125	CR2L-125	125A
250GG-140	25SH140	CR2L-140	140A
250GG-150	25SH150	CR2L-150	150A
250GG-160	25SH160	-	160A
250GG-180	25SH180	-	180A
250GG-200	25SH200	CR2L-200	200A



Dimensions in MM

Ampere Rating	A	B	C	E	F	G	L	T	W
75A to 150A	80	58	31	27	11	9	27	3	20
160A to 200A	87	60	31	31	16	11	32	3	25

I.R.: 100kA at 250VAC

Voltage: 250VAC

Characteristic: Type aR, Very Fast Acting

Pack Size: Varies

Holders: Blocks (p135-136)

Notes: Kyosan brand is manufactured by Hinode.

Options: Trigger indicator fitted version contact sales.

# BRITISH SEMICONDUCTOR FUSE ACCESSORIES



SEMICONDUCTOR

## Trigger Indicators - Replacements

Part Number	RMS Voltage	Peak Voltage	DC Voltage	Overall Length	Cap Diameter
Ti250	250V	TBC	TBC	37.6mm	6.35mm
Ti500	500V	700V	130V	47.5mm	6.35mm
Ti600	600V	TBC	TBC	55.7mm	6.35mm
Ti700	700V	1000V	350V	61.8mm	6.35mm



## Trigger Indicator Kits - Complete Assembly

Part Number	Kit Includes	Suit Fuse Series
EC-250	Ti-250 & 2 x 18mm Clips	LET (421-FF)
MC-250	Ti-250 & 2 x 38mm Clips	LMT & LMMT (571-FF & 572-FF)
EC-600	Ti-600 & 2 x 18mm Clips	FE & ET (621-FF & 631-FF)
EC-600	Ti600- & 2 x 18mm Clips	FEE & EET (701-FF & 722-FF)
MC-700	Ti700- & 2 x 38mm Clips	MT & MMT (861-FF & 862-FF)
MC-600	Ti600- & 2 x 38mm Clips	FM & FMM (851-FF & 852-FF)

Notes: Each kit includes 2 x clips and 1 x trigger indicator.



## Microswitch - Suits Bussmann Trigger Indicators With 6.35mm Diameter.

Part Number  
MAI

### Current Rating:

AC 50/60Hz resistive load @ 250 VRMS: 4A

AC 50/60Hz resistive load @ 127 VRMS: 6A

DC, resistive load @ 110 VDC: 0.7A

DC, Resistive load @ 30 VDC: 2A

### Maximum Working Voltage:

Contact-to-contact (RMS): 1000V

Contact-to-contact (RMS): 1500V

Maximum DC Voltage: 110VDC

Previously: BSMICRO



Microswitch  
Circuit Diagram:



## Assembly Steps:

### STEP 1



2 x Clips fitted to the fuse body.

### STEP 2



Trigger indicator fitted to the clips.

### STEP 3



Microswitch fitted onto the trigger indicator.