

DIN I10 Part Number	Ampere Rating	Body Size	IEC VAC	VDC	Total I ² t at 1000V	Total I ² t at 1250VAC
I70M3238	50A	0/1*	1250	^	815	1 100
I70M3239	63A	0/1*	1250	^	1 300	1 750
I70M3240	80A	0/1*	1250	^	2 500	3 350
I70M3241	100A	0/1*	1250	^	4 450	5 950
I70M3242	125A	0/1*	1250	^	9 000	11 500
I70M3243	160A	0/1*	1250	^	16 000	21 000
I70M3244	200A	0/1*	1250	^	31 000	41 000
I70M3245	250A	0/1*	1250	^	54 500	73 000
I70M3246	315A	0/1*	1250	^	115 000	150 000
I70M3247	350A	0/1*	1250	^	165 000	220 000
I70M3248	400A	0/1*	1250	^	265 000	335 000

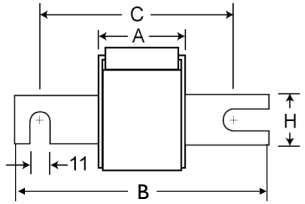

Fuse Fitted with Trigger Indicator and Microswitch Adaptor

I70M4238	160A	1	1250	900	11 500	15 500
I70M4239	200A	1	1250	900	22 500	30 000
I70M4240	250A	1	1250	900	46 000	61 500
I70M4241	315A	1	1250	900	90 000	120 000
I70M4242	350A	1	1250	900	125 000	165 000
I70M4243	400A	1	1250	900	175 000	235 000
I70M4244	450A	1	1250	900	250 000	335 000
I70M4245	500A	1	1250	^	340 000	435 000
I70M4246	550A	1	1250	^	465 000	590 000
I70M4247#	630A	1	1100	^	660 000	-



I70M5238	250A	2	1250	^	38 500	51 500
I70M5239	280A	2	1250	^	55 500	74 500
I70M5240	315A	2	1250	^	77 500	105 000
I70M5241	350A	2	1250	^	97 500	135 000
I70M5242	400A	2	1250	^	140 000	180 000
I70M5243	450A	2	1250	^	205 000	270 000
I70M5244	500A	2	1250	^	285 000	380 000
I70M5245	550A	2	1250	^	370 000	495 000
I70M5246	630A	2	1250	900	575 000	730 000
I70M5247	700A	2	1250	900	795 000	1 050 000
I70M5248	800A	2	1250	900	1 200 000	1 550 000
I70M5249#	900A	2	1100	900	1 750 000	-
I70M5250#	1000A	2	1100	900	2 350 000	-

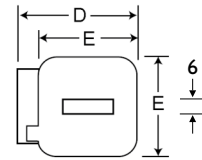

Dimensions in MM

I70M6238	315A	3	1250	900	58 000	775 00
I70M6239	350A	3	1250	900	81 500	110 000
I70M6240	400A	3	1250	900	120 000	160 000
I70M6241	450A	3	1250	900	185 000	245 000
I70M6242	500A	3	1250	900	235 000	310 000
I70M6243	550A	3	1250	900	325 000	435 000
I70M6244	630A	3	1250	900	495 000	665 000
I70M6245	700A	3	1250	900	705 000	940 000
I70M6246	800A	3	1250	1000	995 000	1 300 000
I70M6247	900A	3	1250	1000	1 500 000	1 900 000
I70M6248	1000A	3	1250	1000	2 150 000	2 750 000
I70M6249	1100A	3	1250	1000	2 800 000	3 600 000
I70M6250#	1250A	3	1100	900	3 950 000	-
I70M6251#	1400A	3	1100	900	6 000 000	-

Body Size	DIN I10					
	A	B	C	D	E	H
0/1*	80	138	108	58	45	20
1	80	138	108	66	53	25
2	80	138	108	75	61	25
3	81	139	108	90	76	30

RELATED PRODUCT:

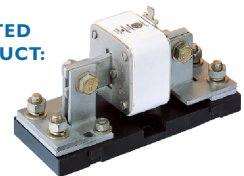

Fuse block with bolted tag fuse

I.R.: 100kA at rated voltage

Voltage: VAC (As listed) 1300VAC (UL)
1250VAC (IEC), # 1100VAC (IEC).
VDC (As listed) ^ Contact sales

Characteristic: Type aR, Very Fast Acting
Pack Size (box): 3

Microswitch (Type K): I70H0069 (p148)

Price & Availability: Please contact sales

Holders: Blocks I70H.. (p137)

Notes: Bussmann Body Size 1* = Size 0.

Approvals: DIN 43653 IEC

Features and Benefits

- Excellent DC performance
- Low arc voltage and low energy let-through (I²t)
- Low watts loss
- Superior cycling capability

Typical Applications

- DC common bus
- DC drives
- Power converters / rectifiers
- Reduced voltage starters