

Type FKE/90	Type FKE/115	Ampere Rating	Body Size	Total I ² t at 660V
170M3658	170M3758	40A	0/1*	270
170M3659	170M3759	50A	0/1*	515
170M3660	170M3760	63A	0/1*	770
170M3661	170M3761	80A	0/1*	1 250
170M3662	170M3762	100A	0/1*	2 450
170M3663	170M3763	125A	0/1*	3 700
170M3664	170M3764	160A	0/1*	7 500
170M3665	170M3765	200A	0/1*	15 000
170M3666	170M3766	250A	0/1*	28 500
170M3667	170M3767	315A	0/1*	46 500
170M3668	170M3768	350A	0/1*	68 500
170M3669	170M3769	400A	0/1*	105 000
170M3670	170M3770	450A	0/1*	140 000
170M3671	170M3771	500A	0/1*	180 000
170M3672	170M3772	550A	0/1*	230 000
170M3673	170M3773	630A	0/1*	325 000
170M4658	170M4758	200A	1	11 500
170M4659	170M4759	250A	1	21 000
170M4660	170M4760	315A	1	42 000
170M4661	170M4761	350A	1	59 000
170M4662	170M4762	400A	1	91 500
170M4663	170M4763	450A	1	120 000
170M4664	170M4764	500A	1	170 000
170M4665	170M4765	550A	1	230 000
170M4666	170M4766	630A	1	350 000
170M4667	170M4767	700A	1	465 000
170M4668	170M4768	800A	1	725 000
170M4669	170M4769	900A	1	850 000
170M5658	170M5758	400A	2	74 000
170M5659	170M5759	450A	2	105 000
170M5660	170M5760	500A	2	145 000
170M5661	170M5761	550A	2	190 000
170M5662	170M5762	630A	2	275 000
170M5663	170M5763	700A	2	405 000
170M5664	170M5764	800A	2	575 000
170M5665	170M5765	900A	2	840 000
170M5666	170M5766	1000A	2	1 250 000
170M5667	170M5767	1100A	2	1 600 000
170M5668	170M5768	1250A	2	2 400 000
170M6658	170M6758	500A	3	95 000
170M6659	170M6759	550A	3	135 000
170M6660	170M6760	630A	3	210 000
170M6661	170M6761	700A	3	300 000
170M6662	170M6762	800A	3	465 000
170M6663	170M6763	900A	3	670 000
170M6664	170M6764	1000A	3	945 000
170M6665	170M6765	1100A	3	1 300 000
170M6666	170M6766	1250A	3	1 950 000
170M6667	170M6767	1400A	3	2 450 000
170M6668	170M6768	1500A	3	3 100 000
170M6669	170M6769	1600A	3	3 900 000
170M6670	170M6770	1800A#	3	5 250 000
170M6671	170M6771	2000A ^	3	6 350 000

I.R.: 200kA at rated voltage
Voltage: 700VAC (UL), 690VAC (IEC),
 #600VAC (IEC), ^ 550VAC (IEC).

Pack Size (box): 3

Holders: Blocks (contact sales for details)

Microswitch (Type K): 170H0069 (p148)

Notes: Bussmann Body Size 1* = Size 0.

Trigger Indicator & Microswitch Adapter

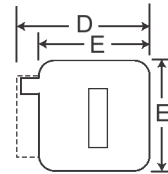
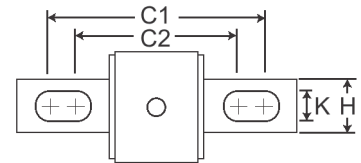
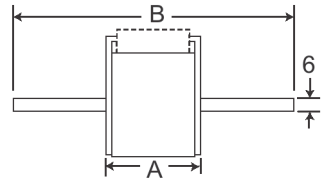
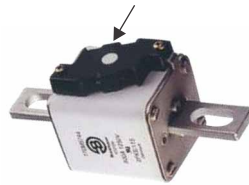

Body		Type FKE/90						
Size	A	B	C1	C2	D	E	H	K
0/1*	50	110	85	72	59	45	20	10
1	50	136	104	78	69	53	25	14
2	50	135	105	78	77	61	25	14
3	51	135	106	77	92	76	36	16

Body		Type FKE/115						
Size	A	B	C1	C2	D	E	H	K
0/1*	50	148	123	110	59	45	20	10
1	50	157	126	100	69	53	25	14
2	50	159	125	99	77	61	25	14
3	51	155	125	97	92	76	36	16

Dimensions in MM

Approvals: IEC