

Type FKE/115		Ampere	Body	Total I ² t	Total I ² t
Part Number	Rating		Size	at 1000V	at 1250V
170M3738	50A		0/1*	815	1 100
170M3739	63A		0/1*	1 300	1 750
170M3740	80A		0/1*	2 500	3 350
170M3741	100A		0/1*	4 450	5 950
170M3742	125A		0/1*	9 000	11 500
170M3743	160A		0/1*	16 000	21 000
170M3744	200A		0/1*	31 000	41 000
170M3745	250A		0/1*	54 500	73 000
170M3746	315A		0/1*	115 000	150 000
170M3747	350A		0/1*	165 000	220 000

170M4738	160A	1		11 500	15 500
170M4739	200A	1		22 500	30 000
170M4740	250A	1		46 000	61 500
170M4741	315A	1		90 000	120 000
170M4742	350A	1		125 000	165 000
170M4743	400A	1		175 000	235 000
170M4744	450A	1		250 000	335 000
170M4745	500A†	1		340 000	-
170M4746	550A‡	1		465 000	-
170M4747	630A‡	1		660 000	-

170M5738	250A	2		38 500	51 500
170M5739	280A	2		55 500	74 500
170M5740	315A	2		77 500	105 000
170M5741	350A	2		97 500	135 000
170M5742	400A	2		140 000	180 000
170M5743	450A	2		205 000	270 000
170M5744	500A	2		285 000	380 000
170M5745	550A	2		370 000	495 000
170M5746	630A	2		575 000	730 000
170M5747	700A†	2		795 000	-
170M5748	800A†	2		1 200 000	-
170M5749	900A‡	2		1 750 000	-
170M5750	1000A‡	2		2 350 000	-

170M6738	315A	3		58 000	77 500
170M6739	350A	3		81 500	110 000
170M6740	400A	3		120 000	160 000
170M6741	450A	3		185 000	245 000
170M6742	500A	3		235 000	310 000
170M6743	550A	3		325 000	435 000
170M6744	630A	3		495 000	665 000
170M6745	700A	3		705 000	940 000
170M6746	800A	3		995 000	1 300 000
170M6747	900A	3		1 500 000	1 900 000
170M6748	1000A‡†	3		2 150 000	-
170M6749	1100A‡†	3		2 800 000	-
170M6750	1250A‡†	3		3 950 000	-
170M6751	1400A‡†	3		6 000 000	-



Fuses Fitted with Trigger Indicator and Microswitch Adaptor

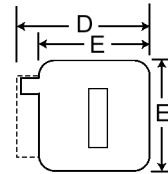
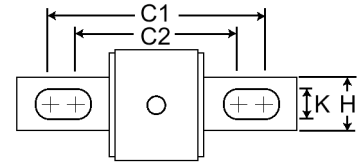
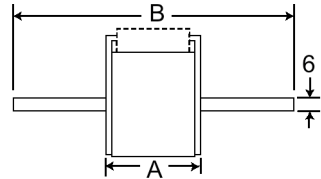

Type FKE/115 Dimensions in MM

Size	A	B	C1	C2	D	E	H	K
0/1*	74	156	130	101	59	45	20	10
1	74	160	127	102	69	53	25	14
2	74	160	127	102	77	61	25	14
3	74	159	128	101	92	76	36	16

I.R.: 100kA at rated voltage
Voltage: 1300VAC (UL), 1250VAC (IEC)
 † Voltage: 1100V (IEC).
 ‡ Voltage: 1000V (IEC).
 ‡ Voltage: 1000V (UL).

Operating Class: aR
Pack Size (box): 3
Microswitch (Type K): 170H0069 (p148)
Holders: Blocks (contact sales for details)
Notes: Bussmann Body Size 1* = Size 0.
Approvals: IEC

Features and Benefits

- Excellent DC performance
- Low arc voltage and low energy let-through (I²t)
- Low watts loss
- Superior cycling capability

Typical Applications

- DC common bus
- DC drives
- Power converters / rectifiers
- Reduced voltage starters