

The C5268 series of fuse blocks provide the user with design and manufacturing flexibility. Two identical half blocks make up a modular fuse block. These split units can be panel mounted any distance apart to accommodate any length fuse. With this design, the fuse terminal and cable (with termination) are mounted on the same stud, minimizing labor needed for installation.

| Part Number | Ampere Rating | Stud Diameter and Thread Type | "A" Stud Height |
|-------------|---------------|-------------------------------|-----------------|
| C5268-5 | 100A | 1/4"-20 UNC (6.35mm) | 1.75" (44.45mm) |
| C5268-3 | 200A | 5/16"-18 UNC (7.93mm) | 0.75" (19.05mm) |
| C5268-2 | 200A | 5/16"-18 UNC (7.93mm) | 1.75" (44.45mm) |

Pack Size (box): 1 block (order 2 blocks per fuse).

Ambient Temp: 150 °C

Base: Plaslok S5440 phenolic, UL 94V-0 or 94V-1.

Studs: Steel, Zinc Plated

Accessories: Includes nut & spring washer.

Notes: Additional nuts and washers (not included) can be fitted on the stud to elevate the fuse body higher above the fuse base if more clearance is required, refer picture. Fuse not included.

***Ordering Information:**

Each fuse requires 2 blocks. The C5268 series is sold as single blocks (order 2 blocks per fuse).



Pair of C5268-2 Blocks*



Pair of C5268-4 Blocks*



Fuse Fitted on a pair of C5268-4 Blocks*

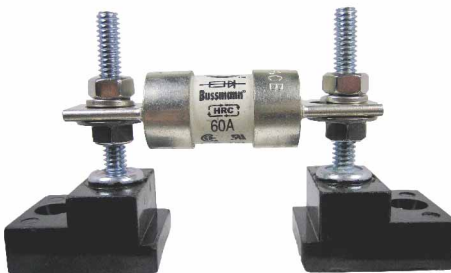

Fuse Fitted on a pair of C5268-5 Blocks*

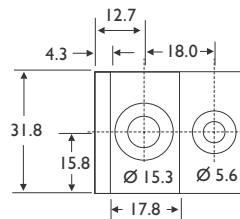
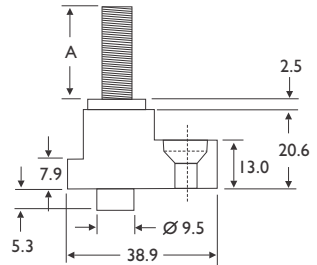

Dimensions in MM

FUSE BLOCK TO FUSE COMPATIBILITY CHART

| Fuse Series | Amp Range | C5268-5 | C5268-3 | C5268-2 |
|-------------|-------------|---------|---------|---------|
| 250GG | 75A - 100A | X | | |
| 250GG | 75A - 150A | | X | X |
| 250GG | 160A - 200A | | X | X |
| 421-FF | 10A - 100A | X | | |
| 571-FF | 160A - 200A | | X | X |
| 621-FF | 35A - 100A | X | | |
| 631-FF | 15A - 80A | X | | |
| 701-FF | 100A - 100A | X | | |
| 701-FF | 100A - 200A | | X | X |
| 722-FF | 75A - 100A | X | | |
| 722-FF | 75A - 160A | | X | X |
| 851-FF | 180A - 200A | | X | X |
| 861-FF | 125A - 200A | | X | X |
| AE5 | 50A - 200A | | | X |
| AE7 | 60A - 200A | | | X |
| AEX | 70A - 200A | | | X |
| ANL | 35A - 100A | X | | |
| ANL | 35A - 200A | | X | X |
| ANN | 10A - 100A | X | | |
| ANN | 10A - 200A | | X | X |
| DFJ | 70A - 100A | X | | |
| EET | 75A - 100A | X | | |
| EET | 75A - 160A | | X | X |
| ET | 15A - 80A | X | | |
| EV20 | 50A - 100A | X | | |
| EV20 | 50A - 150A | | | X |
| EV25 | 100A - 100A | X | | |
| EV25 | 100A - 200A | | | X |
| EV30 | 200A - 200A | | | X |
| FBT | 35A - 100A | X | | |
| FBT | 35A - 200A | | X | X |
| FE | 35A - 100A | X | | |
| FEE | 100A | X | | |
| FEE | 100A - 200A | | X | X |
| FM | 180A - 200A | | X | X |
| FWA | 70A - 100A | X | | |
| FWH | 35A - 60A | X | | X |
| FWH | 70A - 100A | X | | X |
| FWH | 125A - 200A | | | X |
| FWJ | 35A - 60A | X | | X |
| FWJ | 70A - 100A | X | | X |
| FWJ | 125A - 200A | | | X |
| FWP | 5A - 30A | X | | |
| FWP | 35A - 60A | X | | X |
| FWP | 70A - 100A | X | | X |
| FWP | 125A - 200A | | | X |
| FWX | 35A - 60A | X | | X |
| FWX | 70A - 100A | X | | |
| FWX | 70A - 200A | | | X |
| JJN | 70A - 100A | X | | |
| JJN | 110A - 200A | | | X |
| JJS | 70A - 100A | X | | |
| JJS | 110A - 200A | | | X |
| JKS | 70A - 100A | X | | |
| LET | 10A - 100A | X | | |
| LMT | 160A - 200A | | X | X |
| LPJ..SP | 70A - 100A | X | | |
| MT | 160A - 200A | | X | X |
| TPL / LI7T | 70A - 100A | X | | |

Not all recommended holders may be suitable for your circuit.
Please check the holder specifications are suitable for your fuse.