

## DIN NH-TYPE FUSES SIZE 0 (500V & 690V)



| 500VAC gG   | 690VAC aM   | Ampere Rating | Body Size |
|-------------|-------------|---------------|-----------|
| Part Number | Part Number |               |           |
| 0-NB035     | 0-AM035     | 35A           | 0         |
| 0-NB040     | 0-AM040     | 40A           | 0         |
| 0-NB050     | 0-AM050     | 50A           | 0         |
| 0-NB063     | 0-AM063     | 63A           | 0         |
| 0-NB080     | 0-AM080     | 80A           | 0         |
| 0-NB100     | 0-AM100     | 100A          | 0         |
| 0-NB125     | 0-AM125     | 125A          | 0         |
| 0-NB160     | 0-AM160     | 160A          | 0         |
| 0-NB200     | -           | 200A          | 0         |



Dimensions in MM

| Size | A   | B  | C  | D  | E  |
|------|-----|----|----|----|----|
| 0    | 125 | 68 | 56 | 28 | 15 |

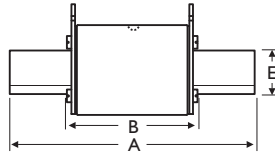

**I.R. 500V:** 120kA at 500VAC (Type gG/gL/aM)

**I.R. 690V:** 100kA at 690VAC (Type gG/gL/aM)

**Pack Size (box):** 3

**Accessories:** NH-Extractor (p150)

**Approvals:** IEC60269-2, DIN 43620, VDE 0636

**Notes:** gL (general application-normal acting).  
aM (motor start-delayed action).

**Features:** 'Flag' indicator located on top plate.

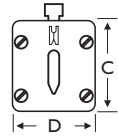

## DIN NH-TYPE FUSES SIZE 1C / 1 (500V & 690V)



| 500VAC gG   | Ampere Rating | Body Size | 690VAC gG   | Ampere Rating | Body Size | 690VAC aM   | Ampere Rating | Body Size |
|-------------|---------------|-----------|-------------|---------------|-----------|-------------|---------------|-----------|
| Part Number |               |           | Part Number |               |           | Part Number |               |           |
| 1C-NB035    | 35A           | 1C        | 1C-GG035    | 35A           | 1C        | 1-AM035     | 35A           | 1         |
| 1C-NB040    | 40A           | 1C        | 1C-GG040    | 40A           | 1C        | 1-AM040     | 40A           | 1         |
| 1C-NB050    | 50A           | 1C        | 1C-GG050    | 50A           | 1C        | 1-AM050     | 50A           | 1         |
| 1C-NB063    | 63A           | 1C        | 1C-GG063    | 63A           | 1C        | 1-AM063     | 63A           | 1         |
| 1C-NB080    | 80A           | 1C        | 1C-GG080    | 80A           | 1C        | 1-AM080     | 80A           | 1         |
| 1C-NB100    | 100A          | 1C        | 1C-GG100    | 100A          | 1C        | 1-AM100     | 100A          | 1         |
| 1C-NB125    | 125A          | 1C        | 1C-GG125    | 125A          | 1C        | 1-AM125     | 125A          | 1         |
| 1C-NB160    | 160A          | 1C        | 1-GG160     | 160A          | 1         | 1-AM160     | 160A          | 1         |
| 1-NB200     | 200A          | 1         | 1-GG200     | 200A          | 1         | 1-AM200     | 200A          | 1         |
| 1-NB224     | 224A          | 1         | 1-GG224     | 224A          | 1         | 1-AM224     | 224A          | 1         |
| 1-NB250     | 250A          | 1         | 1-GG250     | 250A          | 1         | 1-AM250     | 250A          | 1         |
| 1-NB315     | 315A          | 1         |             |               |           |             |               |           |
| 1-NB355     | 355A          | 1         |             |               |           |             |               |           |

**I.R. 500V:** 120kA at 500VAC (Type gG/gL/aM) 35A - 250A

**I.R. 440V:** 120kA at 440VAC (Type gG/gL) 315A - 355A

**I.R. 690V:** 100kA at 690VAC (Type gG/gL/aM) 35A - 250A

**Voltage:** VAC as rated. VDC call for confirmation.

**Pack Size (box):** 3

**Holders:** Bases (p139), Disconnect Switches (p142-143)

**Accessories:** NH-Extractor (p150)

**Notes:** Contact sales for ratings below 35A (1C series).

**Approvals:** IEC60269-2, DIN 43620, VDE 0636

**Notes:** gL (general application-normal acting). aM (motor start-delayed action).

**Features:** 'Flag' indicator located on top plate of fuse is standard.



Dimensions in MM

| Size | A   | B  | C  | D  | E  |
|------|-----|----|----|----|----|
| 1C   | 135 | 68 | 61 | 28 | 15 |
| 1    | 135 | 72 | 65 | 46 | 20 |

