

FUSED BATTERY DISTRIBUTION UNIT 10 WAY



Features:

- Suits 8 x Maxi fuses & 2 x Midi fuses (not included).
- 2 Hinged covers for easy access to either Maxi fuses or Midi fuses.
- Simple double ring (19mm) connection to positive battery terminal.
- Includes battery charging terminal & one fuse puller.
- Opening for the starter cable to pass into unit.
- A large assortment of terminals & power connectors (not included).
- 4 colour-coded sockets for polarized power connectors to Maxi fuses.
- Common feed powers all fuse positions.

Part

Part Number	Description
00710	10 Way Fused Battery Power Distribution Unit
40300	Maxi Fuse Connector Female Black - Non polarized
40310	Maxi Fuse Connector Female Blue - Polarized
40340	Maxi Fuse Connector Female Grey - Polarized
40325	Maxi Fuse Connector Female Green -Polarized
40330	Maxi Fuse Connector Female Brown -Polarized
07650	Maxi Fuse Connector F Terminal 1.5 to 2.5mm ² 20A (BK/RL)
07660	Maxi Fuse Connector F Terminal 4 to 6mm ² 36A (BK/RL)
07670	Maxi Fuse Connector F Terminal 8 to 10mm ² 50A (BK/RL)
07671	Maxi Fuse Connector F Terminal 16mm ² 75A (BK/RL)
08240RL	Midi Fuse Terminal 2.5 to 4mm ² 28A, M5 (RL) (Pack 3000)
08245RL	Midi Fuse Terminal 6.0 to 8mm ² 48A, M5 (RL) (Pack 2400)
08250RL	Midi Fuse Terminal 10 to 16mm ² 75A, M5 (RL) (Pack 2400)
05925RL	Midi Fuse Terminal 25 to 35mm ² 125A, M5 (RL) (Pack 800)

Ordering Notes:

1. Distribution unit does not include fuses, terminals or connectors.
 2. Only 1 x Midi terminal is required for each Midi fuse.
 - 3.*Each connector plugs into 2 x Maxi fuses and requires 2 terminals.
- Non-polarized (black) connector plugs into any of the 4 sockets. Polarized connectors only plug into their colour-coded socket eg. blue connector into blue socket. Each connector plugs into 2 x Maxi fuses.

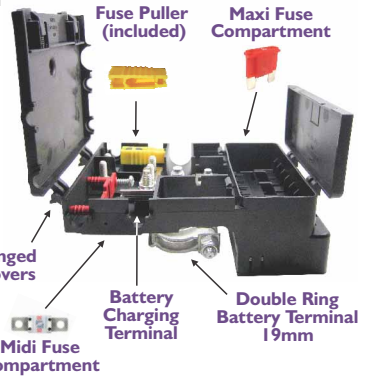
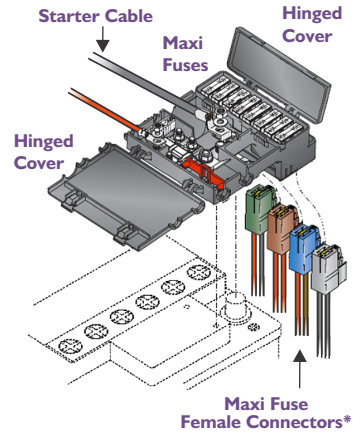

Circuit Diagram

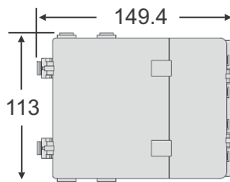
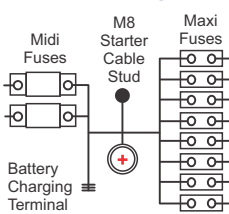

Dimensions in MM

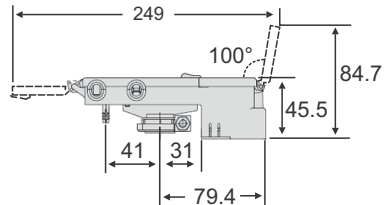

RELATED PRODUCTS:



Maxi Fuse
(see p. 18)



Midi Fuse
(see p.24)

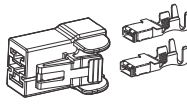

Maxi Fuse Connector & Female Terminals



(2.5 - 4mm²)
(6.0 - 8mm²)



(10 - 16mm²)



(25-35mm²)
Polarity B

Midi Fuse M5 Terminals (Indent Items)