

POWER DIST. MODULE SEALED - 24 POSITION



IP67 **NEW**
58V

The FRH-A24 is a 24 position power distribution module providing a compact, durable and sealed power distribution solution for the transportation market. This module can be fitted with a mix of 280 style components such as Mini fuses, Mini Circuit Breakers, Mini Diodes, Diode Keys, Mini Resistors, ISO 280 Ultra Micro and ISO 280 Micro relays.

- Voltage Rating:** 58VDC **Rating:** 250A
- Terminal Capacity:** 24 terminals on a layout matrix of (4 x 6).
- Terminal Rating:** 30A continuous.
- Terminals:** Delphi Metri-Pack 280 Female Sealed TANGED.
- Temperature Rating:** -40°C to +125°C.
- Housing:** Black thermoplastic. **Seal:** Silicone, red.
- Mounting Bracket:** Stainless steel, straight with anti-rotation tab.
- Cable Seals:** Please check the overall diameter of your cable before ordering cable seals. Silicone material UL94-V0.
- Cavity Plugs:** Required to fill unused output cavities for ingress protection. Silicone material.
- Ingress Protection Rating:** IP67.
- Terminal Tools:** Terminal crimping & removal tools available.
- Module Accessories:** Optional 90 degree mounting bracket.
- Components:** Mini fuses, mini circuit breakers and ISO 280 relays are not included with the kit.
- Approvals:**

Assembled Unit



PDMKIT424 - PDM & Terminal Kit

Part Number	Kit Contents
PDMKIT424	Base, Seal, Cover, S.Steel Bracket, 2 x TPA's, CPA, 26 x Terminals (12129493), 26 x Seals (15324980), 6 x Cavity Plugs (12010300).

Part Number	Description
FRH-A24	PDM Housing Black and Seal Red. 24 Position.
FRH-A24-C	PDM Cover Black.
FRH-A-CPA	PDM CPA Blue Cover Position Assurance.
FRH-A12-MB-A2	Flat Bracket Anti-Rotation Tabs Stainless Steel.
FRH-A12-T	TPA Terminal Position Assurance, 2pcs Required
PDM-TK	Diode Key Red Nylon. Drops into PDM Base Slots
12084201	Tanged Terminal Female (#22-20AWG), 0.35 - 0.5mm ²
12077411	Tanged Terminal Female (#18-16AWG), 0.80 - 1.0mm ²
12129493	Tanged Terminal Female (#14-12AWG), 2.0 - 3.0mm ²
12077413	Tanged Terminal Female (#10AWG), 5.0mm ²
15324983	Cable Seal, 1.70 - 1.29mm Cable Diameter Dark Red
15324982	Cable Seal, 2.85 - 2.03mm Cable Diameter Green
15324980	Cable Seal, 3.49 - 2.81mm Cable Diameter Grey
15324981	Cable Seal, 4.30 - 3.45mm Cable Diameter Blue
12010300	Cavity Plug, 6.7mm Cavity inside Diameter Green

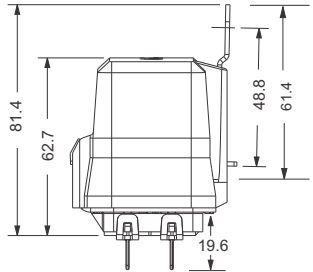

Dimensions are in MM

ACCESSORIES: Delphi Metri-Pack 280

TERMINALS: TANGED

Female Sealed,
Tin Brass / Tin Plated



CABLE SEALS: CAVITY PLUG:

Silicone



RELATED PRODUCTS:



**Mini & LED Fuses,
Circuit Breakers,
Transorbs, Diodes,
Shunts & Diode Key**



**ISO 280 Relays
Ultra Micro,
Micro & Mini.
12VDC & 24VDC.**



**Tanged Cables,
Jumpers &
Connectors.**
(see p.186)

Scan this
QR Code
for more
information



QR Code: 9038

