

## STUD TYPE JUNCTION BLOCKS - STAND ALONE

Heavy-duty ground or power connection points in AC or DC circuits. Ideal for creating a centralized power distribution or grounding point.

Part Number	Body Colour	Amp Rating	Thread Size M	Stud Material	Stud Plating	Dia.	Dimensions in MM										
							A	B	C	D	E	F	H	K			
C1933	Black	400A	1/2"-13	Brass	Zinc	1	69.8	36.6	31.7	38.1	28.6	9.5	4.8	50.8			
C1933R	Red	400A	1/2"-13	Brass	Zinc	1	69.8	36.6	31.7	38.1	28.6	9.5	4.8	50.8			
C1933-6B	Black	250A	3/8"-16	Brass	Zinc	1	69.8	36.6	31.7	38.1	28.6	9.5	4.8	50.8			
C1933-6R	Red	250A	3/8"-16	Brass	Zinc	1	69.8	36.6	31.7	38.1	28.6	9.5	4.8	50.8			
JB3816-2	Black	250A	3/8"-16	Steel	Zinc	2	54.0	24.9	15.9	22.2	17.5	7.9	1.6	34.9			
JB3816-3	Red	250A	3/8"-16	Steel	Zinc	2	54.0	24.9	15.9	22.2	17.5	7.9	1.6	34.9			
JB51618-2*	Black	250A	5/16"-18	Stainless	N/A	2	54.0	24.9	22.0	22.2	17.5	8.0	1.6	34.9			
JB51618-3*	Red	250A	5/16"-18	Stainless	N/A	2	54.0	24.9	22.0	22.2	17.5	8.0	1.6	34.9			

**Voltage:** AC / DC  
**Body:** Thermoplastic (\*Glass Filled Nylon)  
**Mounting Torque Rating:** 5.4Nm max.  
**Hardware:** Hex Nut & Spring Washer Inc.  
**Pack Size:** 1, 10, 50  
**Diagrams:** See below.  
**Notes:** \*JB51618-x rated 250A at 12VDC, 48VDC max.



**C1933**  
1/2"-13 Stud



**JB3816-3**  
3/8"-16 Stud



**JB51618-2**  
5/16"-18 Stud

## STUD TYPE JUNCTION BLOCKS - FEED THROUGH

Feed-Through blocks are designed to be used on a firewall or panel.

Part Number	Body Colour	Amp Rating	Thread Size M	Stud Mat.	Stud Plating	Dia.	Dimensions in MM														
							A	B	C	D	E	F	G	H	I	J	K				
C1925B	Black	400A	1/2"-13	Brass	Zinc	1	69.8	38.1	31.7	31.7	28.6	9.5	28.6	4.8	4.8	50.8					
C1925	Red	400A	1/2"-13	Brass	Zinc	1	69.8	38.1	31.7	31.7	28.6	9.5	28.6	4.8	4.8	50.8					
C1925-2B	Black	250A	3/8"-16	Brass	Tin	1	69.8	38.1	31.7	31.7	28.6	9.5	28.6	4.8	4.8	50.8					
C1925-2	Red	250A	3/8"-16	Brass	Tin	1	69.8	38.1	31.7	31.7	28.6	9.5	28.6	4.8	4.8	50.8					
C1938-1	Black	200A	5/16"-18	Brass	Tin	2	52.4	23.8	17.5	22.2	17.5	7.9	23.8	1.6	1.6	33.3					
C1938-1R	Red	200A	5/16"-18	Brass	Tin	2	52.4	23.8	17.5	22.2	17.5	7.9	23.8	1.6	1.6	33.3					
C1938	Black	250A	3/8"-16	Brass	Zinc	2	52.4	23.8	17.5	22.2	17.5	7.9	23.8	1.6	1.6	33.3					
C1938R	Red	250A	3/8"-16	Brass	Zinc	2	52.4	23.8	17.5	22.2	17.5	7.9	23.8	1.6	1.6	33.3					
C2791	Black	100A	1/4"-20	Brass	Zinc	3	52.4	17.5	11.2	15.9	17.5	7.9	17.5	1.6	1.6	33.3					
C2791-R	Red	100A	1/4"-20	Brass	Zinc	3	52.4	17.5	11.2	15.9	17.5	7.9	17.5	1.6	1.6	33.3					

**Voltage:** AC / DC  
**Body:** Thermoplastic  
**Studs:** Brass  
**Mounting Torque Rating:** 5.4Nm max.  
**Hardware:** Hex Nuts & Spring Washers Inc.  
**Pack Size:** 1, 10, 50  
**Diagrams:** See below.



**C1925**  
1/2"-13 Stud



**C1938**  
3/8"-16 Stud



**C2791-R**  
1/4"-20 Stud

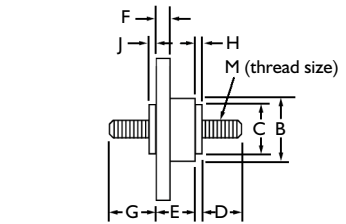
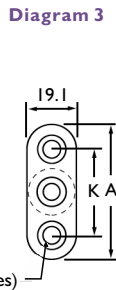
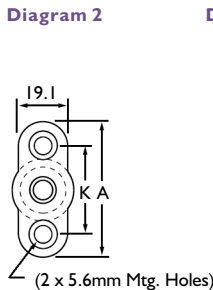
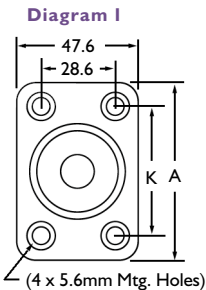

Note 'G' & 'J' dimensions are not applicable to stand alone type.