

## STUD JUNCTION TERMINAL BLOCKS #10-32

Part Number	Nbr. of Positions	Dimensions in MM		
		A	B	C
C5237-1	1	50.8	31.7	-
C5237-2	2	66.7	47.5	15.9
C5237-3	3	82.5	63.4	31.7
C5237-4	4	98.4	79.4	47.5
C5237-6	6	130.8	111.1	79.4
C5237-8	8	161.9	142.9	111.1
C5237-10	10	193.7	174.6	142.9
C5237-12	12	225.4	206.4	174.6

**Rating & Voltage:** 30A at 600V (CSA)  
30A at 300V (UL)

**Body:** Black Thermoplastic

**Studs:** Yellow zinc plated brass. # 10-32 threaded studs on 0.625" (15.9mm) centers. Studs feature a "dog point" to guide nut onto thread.

**Torque Rating:** 2.8Nm max.

**Mounting Holes:** 9/32" x 3/8" Slot. (7.14mm x 9.52mm)



**Hardware:** Nuts & washers included.

**Pack Size:** Please call sales.

**Temperature Rating:** 120°C

**Features:** Numbers & arrows molded on top of barriers to indicate terminals.

**Notes:** Extended range also available contact sales.

**Approvals:**   

**C5237**  
# 10-32 Stud

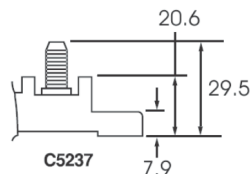
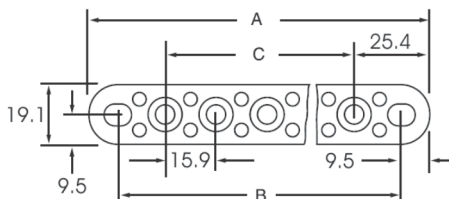

Dimensions in MM

Mtg. holes 9/32" x 3/8" slot

**C5237**

## STUD JUNCTION TERMINAL BLOCKS #10-24

Part Number	Nbr. of Positions	Dimensions in MM		
		A	B	C
C4559-2	2	76.2	57.1	19.0
C4559-3	3	95.2	76.2	36.1
C4559-4	4	114.3	95.2	57.1
C4559-5	5	133.3	114.3	76.2
C4559-6	6	152.4	133.3	95.2
C4559-8	8	190.5	171.4	133.3
C4559-10	10	228.6	209.5	171.4
C4559-12	12	266.7	247.6	209.5

**Rating & Voltage:** 30A at 600V

**Body:** Black Thermoplastic

**Studs:** Zinc plated steel. # 10-24 threaded studs on 0.75" (19mm) centers. Studs feature a "dog point" to guide nut onto thread.

**Torque Rating:** 2.7Nm max.

**Mounting Holes:** 9/32" x 3/8" Slot. (7.14mm x 9.52mm)

**Pack Size:** Please call sales.

**Options:** Nuts & washers included.

**Temperature Rating:** 120°C

**Features:** Numbers & arrows molded on top of barriers to indicate terminals.

**Approvals:**   

**C4559**  
# 10-24 Stud

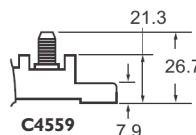
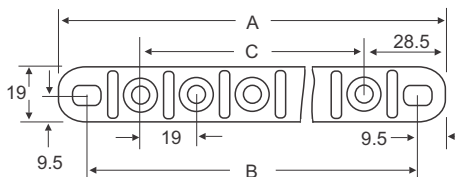

Dimensions in MM

Mtg. holes 9/32" x 3/8" slot

**C4559**