

STUD TYPE JUNCTION BLOCKS - STAND ALONE

Heavy-duty ground or power connection points in AC or DC circuits. Ideal for creating a centralized power distribution or grounding point.



C1933
1/2"-13 Stud



C1933R
1/2"-13 Stud



C1933-6B
3/8"-16 Stud



C1933-6R
3/8"-16 Stud



JB3816-2
3/8"-16 Stud



JB3816-3
3/8"-16 Stud



JB51618-2
5/16"-18 Stud



JB51618-3
5/16"-18 Stud

Part Number	Body Colour	Amp Rating	Thread Size M	Stud Material	Stud Plating	Dia.	Dimensions in MM							
							A	B	C	D	E	F	H	K
C1933	Black	400A	1/2"-13	Brass	Zinc	1	69.8	36.6	31.7	38.1	28.6	9.5	4.8	50.8
C1933R	Red	400A	1/2"-13	Brass	Zinc	1	69.8	36.6	31.7	38.1	28.6	9.5	4.8	50.8
C1933-6B	Black	250A	3/8"-16	Brass	Zinc	1	69.8	36.6	31.7	38.1	28.6	9.5	4.8	50.8
C1933-6R	Red	250A	3/8"-16	Brass	Zinc	1	69.8	36.6	31.7	38.1	28.6	9.5	4.8	50.8
JB3816-2	Black	250A	3/8"-16	Steel	Zinc	2	54.0	24.9	15.9	22.2	17.5	7.9	1.6	34.9
JB3816-3	Red	250A	3/8"-16	Steel	Zinc	2	54.0	24.9	15.9	22.2	17.5	7.9	1.6	34.9
JB51618-2*	Black	250A	5/16"-18	Stainless	N/A	2	54.0	24.9	22.0	22.2	17.5	8.0	1.6	34.9
JB51618-3*	Red	250A	5/16"-18	Stainless	N/A	2	54.0	24.9	22.0	22.2	17.5	8.0	1.6	34.9

POWER DIST.

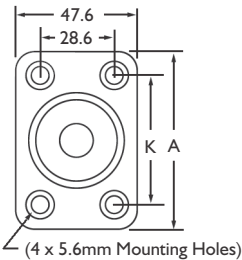

Diagram 1

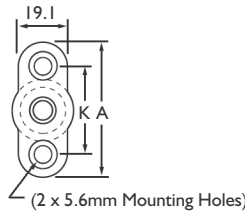
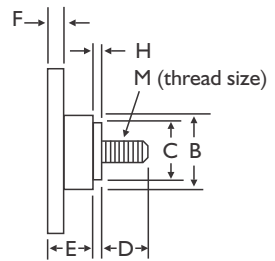

Diagram 2



Voltage: AC / DC

Body: Thermoplastic (*Glass Filled Nylon)

Mounting Torque Rating: 5.4Nm max.

Hardware: Hex nut & spring washer supplied in bulk. Also available without hardware.

Pack Size: 1, 10, 50, 100

Notes: *JB51618-x rated 250A at 12VDC, 48VDC max.