

MINI ISO RELAYS WITH BRACKET 896H SERIES

NEW

SONG CHUAN

Part Number	Volt	Contact Action	Contact		Terminals	Protection	Steel Bracket	Enclosure
			N/O	N/C				
896H1AHCISR112	12V	SPST	50A	-	4 x 6.3mm	½W 680Ω resistor	Yes	Sealed
896H1CHCISR112	12V	SPDT	50A	30A	5 x 6.3mm	½W 680Ω resistor	Yes	Sealed
896H1AHCISR124	24V	SPST	20A	-	4 x 6.3mm	½W 2700Ω resistor	Yes	Sealed
896H1CHCISR124	24V	SPDT	20A	15A	5 x 6.3mm	½W 2700Ω resistor	Yes	Sealed

Details: Refer 896H Series on page 166.

Pack Size: 1pc, 10pcs, 100pcs, 400pcs.

Approval: ELV-2000/53/EC 

Notes: Steel bracket is removable.

RELATED PRODUCTS:

4 Pin SPST

5 Pin SPDT

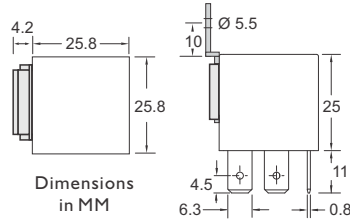
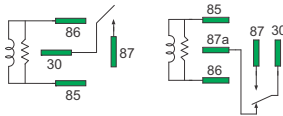

Sealed Relay with Steel Bracket

MINI ISO SKIRTED RELAYS WITH BRACKET 896H SERIES

IP66

NEW

SONG CHUAN

Part Number	Volt	Contact Action	Contact		Terminals	Protection	Steel Bracket	Waterproof Enclosure
			N/O	N/C				
896H1CHDISWR112	12V	SPDT	50A	30A	5 x 6.3mm	½W 680Ω resistor	Yes	Skirted
896H1CHDISWR124	24V	SPDT	20A	15A	5 x 6.3mm	½W 2700Ω resistor	Yes	Skirted

Relay Circuit Diagram

All Terminals

6.3mm (1/4")

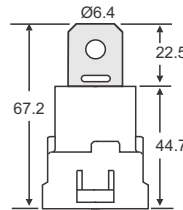
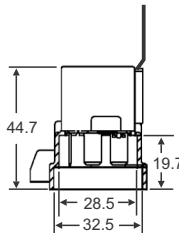
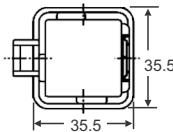
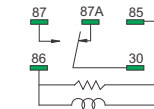

RELATED PRODUCT:



Sealed Relay Connector
(see p.172)

Dimensions in MM

Skirted Relay with Removable Steel Bracket

MINI ISO RELAYS WITH FUSE, FUSE COVER & BRACKET

IP65

NEW

CE **RoHS**

Part Number	Volt	Contact Action	Contact		Terminals	Protection	Suits Fuse. Not Included	Steel Bracket	Fuse Cover
			N/O	N/C					
995850	12V	SPST	30A	-	4 x 6.3mm	resistor	1A to 30A	Yes	Yes
995870	24V	SPST	15A	-	4 x 6.3mm	resistor	1A to 15A	Yes	Yes

RELATED PRODUCTS:



Auto & LED Auto Fuses
(see p.17)

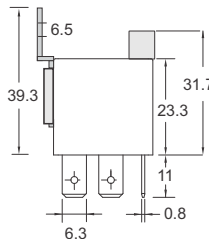
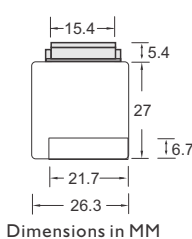

Clear Fuse Cover and Steel Bracket are Both Removable

PROLEC

Email: info@prolecproducts.com.au
Web: www.prolecproducts.com.au