

## MINI RELAY CONNECTOR KIT - SINGLE (4 OR 5 PIN)



Part Number	Description
10246K	Mini Relay Socket Connector Kit includes: 1 x 10246 (Mini relay connector) 5 x 01650BK (Terminals 1-2.5mm <sup>2</sup> 20A, F6.3mm)

**Voltage:** 32VDC  
**Pack Size:** 1, 10, 100  
**Approvals:**

**RELATED PRODUCTS:**  
 ISO Mini Relays see page 166

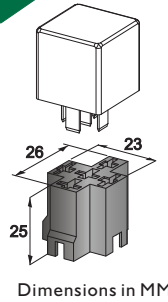

## MINI RELAY HOLDER KIT - SINGLE (4 OR 5 PIN)



Part Number	Description
50135K	Mini Relay Holder Kit includes: 1 x 10245 (Mini relay holder) 1 x 00430 (Fixing plate single screw) 5 x 01650BK (Terminals 1-2.5mm <sup>2</sup> 20A, F6.3mm)

**Voltage:** 32VDC  
**Pack Size:** 1, 10  
**Features:** Gangable.  
**Approvals:**

**RELATED PRODUCTS:**  
 ISO Mini Relays see page 166

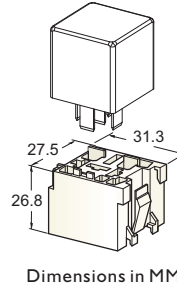
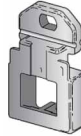

## MAXI RELAY HOLDER KIT - SINGLE (4 PIN)



Part Number	Description
50136K	Maxi Relay Holder Kit includes: 1 x 10247 (Maxi relay holder) 1 x 00430 (Fixing plate single screw) 2 x 07000BK (Terminals 0.5-1.5mm <sup>2</sup> F6.3mm) 2 x 01720BK (Terminals 6-10mm <sup>2</sup> F9.5mm)

**Voltage:** 32VDC  
**Pack Size:** 1, 10  
**Features:** Gangable.  
**Approvals:**

**RELATED PRODUCTS:**  
 ISO Maxi Relays see page 168

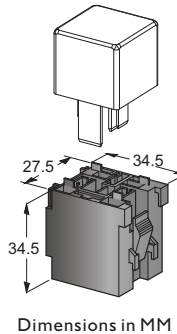
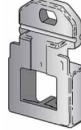

RELAY + SWITCH

Many of MTA's products feature a snap lock wall design. This allows products to be expanded or combined. Use this clever feature to create your own custom combination of fuses and relays.



**Snap Mount Fixing Plate**  
 (see p.78-79)



**Screw Mount Fixing Plate**  
 (see p.78-79)



**Slide Lock M & F Bolt Down Brackets**  
 (see p.78-79)



**Slide Lock Fuse Holders**  
 (see p.78-79)



**Slide Lock Relay Holders**  
 (as above)



**Lateral Lock To Modules**  
 (see p.137 & 141)