

MASTER DISCONNECT SWITCH 6-32VDC



The 75920 Master Battery Disconnect switch is designed to protect service personnel and your vehicle systems. The switch protects vehicles from both battery drain and theft as well as allowing service personnel to lock-out tag-out. It also serves as an effective emergency power cutoff.



Features

- High amperage capacity: 400A at 12V DC.
- Can be used in high side or low side applications.
- Waterproof and dustproof to IP68.
- Composite engineered polymer housing will not rust or corrode.
- Tested per SAE I 455 for salt, calcium chloride and magnesium chloride.
- Large red knob is easy to operate with gloves.
- 90° switch travel makes it easy to identify the switch position.
- Large divider on base prevents accidental shorting of high energy cables.
- Fits standard Master Disconnect mounting pattern.



Part Number	Voltage	Circuitry	Ingress Rating	Switch Pos Symbol	Feature	Actuator Colour
75920	6V-36V	SPST	IP68	"On"- "Off"	Lockout	Red
75920-01	6V-36V	SPST	IP68	"On"- "Off"	Lockout	Yellow

Mounting: Panel Mount

Continuous Current: 12V:400A
24V:300A
36V:200A

Intermittent Current: 12V: 1000A, 90sec on, 5 min off.
12V: 1500A, 60sec on, 5 min off.
12V: 2000A, 30sec on, 5 min off.
12V: 3000A, 15sec on, 5 min off.

Operating Temperature: -40 to 85 degC

Terminal Studs : Copper 3/8"-24.

Hardware: Stainless steel nuts (included)

Corrosion Test: 96 hours - salt spray test to ASTM standard.

Vibration and Shock Test: SAE J1455

Ingress Protection Rating: IP68.

Approvals: SAE CE RoHS



Mounting Diagram

#1 Without Panel Punch

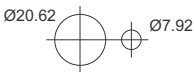

#2 With Panel Punch

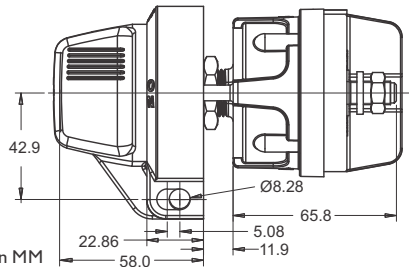
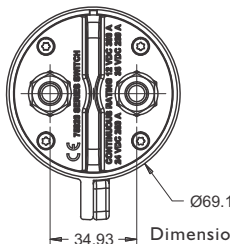
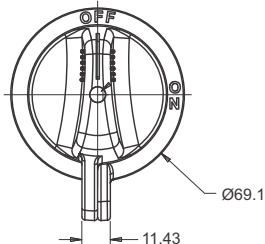
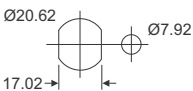

Dimensions in MM



Email: info@prolecproducts.com.au
Web: www.prolecproducts.com.au