

# MASTER DISCONNECT SWITCH 36-48VDC



The Littelfuse Master Disconnect Switch isolates the batteries and eliminates battery drain when vehicle is stored overnight or for longer periods. Electrically cuts off battery power for safety or when the vehicle is being serviced. Units have a depth of only 75mm (knob front to end of studs), can be installed in locations where behind-panel space is limited.

## Features

- 300A continuous current rating.
- Lockout feature. Padlock capability.
- Switch can be mounted anywhere on the vehicle.
- Plastic construction will not corrode.
- Stands up to road splash and salt spray.
- Ingress protected to IP67/ IP69K.
- Ignition protected to SAE J1171 and ISO 8846 for installation in a battery box or on vehicles carrying hazardous loads.
- Stainless steel hardware (included) and tin-plated copper contacts minimize resistance in harsh environments.



Part Number	Voltage	Amperage	Cranking Rating 12VDC, 30 Sec	Circuitry	Ingress Rating	Feature
880064	48V	300A	1250A (1 x 4/0 cable)	SPST	IP67 / IP69K	Lockout
880154	32V	600A	2500A (1 x 4/0 cable)	SPST	IP67 / IP69K	High Cranking & Lockout

**Mounting:** Flange Mount.

**Terminal Stud Size:** 3/8" - 16 (accepts M10 terminals).

**Terminal Studs:** Tin-plated copper.

**Hardware:** Stainless steel nuts (included).

**Ingress Protection Rating:** IP67 / IP69K.

**Ignition Protection:** Meets ISO 8846 & SAE J1171

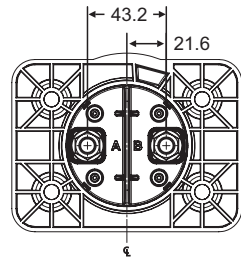
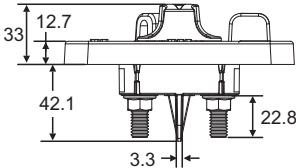

## Wiring Configuration

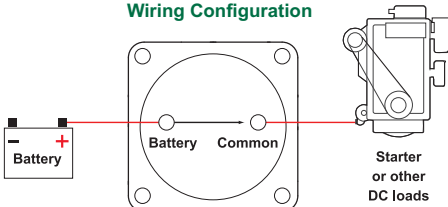

Master Battery Disconnect (shown in ON state)

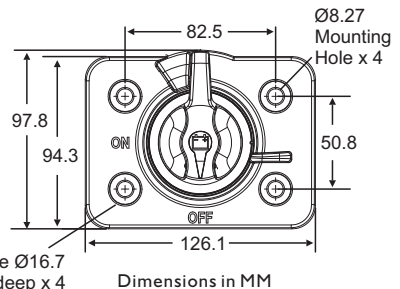

C'Bore Ø16.7  
4.57 deep x 4

RELAY + SWITCH