

# MEGA FUSE RIVETED 32V



Designed and patented by Littelfuse, the MEGA fuse is ideal for battery, alternator connectors and other heavy gauge cables.

Part Number	Ampere Rating	Font Colour	
0298040	40A	White	<input type="checkbox"/>
0298060	60A	White	<input type="checkbox"/>
0298080	80A	Red	<input type="checkbox"/>
0298100	100A	Yellow	<input type="checkbox"/>
0298125	125A	Green	<input type="checkbox"/>
0298150	150A	Orange	<input type="checkbox"/>
0298175	175A	White	<input type="checkbox"/>
0298200	200A	Blue	<input type="checkbox"/>
0298225	225A	Tan	<input type="checkbox"/>
0298250	250A	Pink	<input type="checkbox"/>
0298300*	300A	Grey	<input type="checkbox"/>
0298350*	350A	Green	<input type="checkbox"/>
0298400*	400A	Purple	<input type="checkbox"/>
0298450*	450A	Orange	<input type="checkbox"/>
0298500*	500A	Brown	<input type="checkbox"/>

**Voltage:** 32VDC **I.R.:** 2kA at 32VDC.  
**Characteristic:** Slow Acting \* Short circuit protectors only.  
**Terminals:** 40A & 60A (Silver plated) Brass, 80A - 500A Copper.  
**Mounting:** M8 or 5/16" studs.  
**Options:** 120VDC, 60A to 650A, 56mm fixing, 0888 Series.  
**Pack Size:** 1, 10, 100, 500  
**Approvals:** ISO 8820-5 RoHS

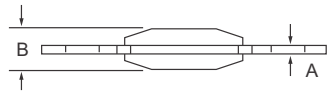
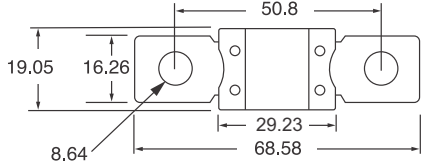

Dimensions in MM

Amp Ratings	A	B
40A - 250A	1.02	9.9
300A - 500A	1.83	10.67

FUSES + KITS

## RELATED PRODUCTS:



# MEGAFUSE 32V & 70V

32V Part Number	70V Part Number	Ampere Rating	Font / Body Colour	
MEG040	MEG040-70V	40A	White	<input type="checkbox"/>
-	MEG050-70V	50A	White	<input type="checkbox"/>
MEG060	MEG060-70V	60A	Lt. Blue	<input type="checkbox"/>
MEG080	MEG080-70V	80A	Red	<input type="checkbox"/>
MEG100	MEG100-70V	100A	Yellow	<input type="checkbox"/>
MEG125	MEG125-70V	125A	Green	<input type="checkbox"/>
MEG150	MEG150-70V	150A	Orange	<input type="checkbox"/>
MEG175	MEG175-70V	175A	White	<input type="checkbox"/>
MEG200	MEG200-70V	200A	Blue	<input type="checkbox"/>
MEG225	MEG225-70V	225A	Tan	<input type="checkbox"/>
MEG250	MEG250-70V	250A	Pink	<input type="checkbox"/>
MEG300	MEG300-70V	300A	Grey	<input type="checkbox"/>
MEG350	MEG350-70V	350A	Green	<input type="checkbox"/>
MEG400	MEG400-70V	400A	Purple	<input type="checkbox"/>
MEG450	MEG450-70V	450A	Orange	<input type="checkbox"/>
MEG500	MEG500-70V	500A	Brown	<input type="checkbox"/>

**Voltage (32VDC): I.R.:** 1.0kA at 32VDC  
**Voltage (70VDC): I.R.:** 2.5kA at 70VDC  
**Characteristic:** Slow Acting  
**Pack Size:** 1, 10, 100, 400  
**Holders:** Inline, Blocks & Power Dist. Unit.  
**Mounting:** M8 or 5/16" studs.  
**Approvals:** ISO 20934 RoHS

## RELATED PRODUCTS:



NEW

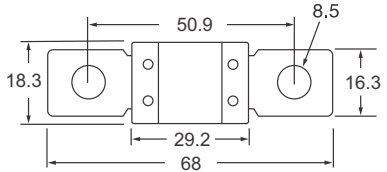

Dimensions in MM



Email: info@prolegproducts.com.au  
 Web: www.prolegproducts.com.au