

ELECTRIC VEHICLE PDU FUSES AE6 1000V



Engineered to provide auxiliary and high performance protection for hybrid and electric vehicles.



Cartridge	Flush Tag	Ampere Rating	Cap Dia.
Part Number	Part Number		
AE61500A00	AE61500A02	5A	10
AE61600A00	AE61600A02	6A	10
AE61800A00	AE61800A02	8A	10
AE62100A00	AE62100A02	10A	10
AE62150A00	AE62150A02	15A	10
AE62200A00	AE62200A02	20A	10
AE62250A00	AE62250A02	25A	10
AE62300A00	AE62300A02	30A	10
--	AE62200B02	20A	14
--	AE62250B02	25A	14
--	AE62300B02	30A	14
AE62350B00	AE62350B02	35A	14
AE62400C00	AE62400C02	40A	14
AE62500C00	AE62500C02	50A	14
AE62600C00	AE62600C02	60A	14

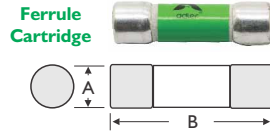

Series	Amperage	A	B
AE6...A00	5A - 30A	10	38
AE6...B00	20A - 35A	14	51
AE6...C00	40A - 60A	14	65

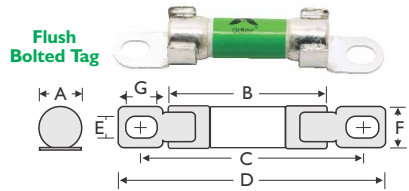

Voltage: 1000VDC **I.R.:** 20kA at 1000VDC.
Time Constant: 2 ± 0.5ms
Terminal Options: Centre tag, PCB mount & vertical mount.
Approvals: ISO 8820-8; GB/T 31465.6; UL 248-20, JASO D622

RELATED PRODUCTS:



Fuse Clips
(see p.68)



Fuse Blocks
(see p.102)



Modular Fuse Blocks
(see p.104)

Series	Amperage	A	B	C	D	E	F	G
AE6...A02	5A - 15A	10.3	38	53.5	64	5.3	12	7
AE6...B02	20A - 35A	14.2	51	72.0	86	6.5	12	9.4
AE6...C02	40A - 60A	14.2	65	87.0	101	6.5	12	9.4

ELECTRIC VEHICLE PDU FUSES AEX 1000V



Designed for EV / HEV automotive use such as high power EV PDU & battery protection.



Part Number	Ampere Rating	Dia.
AEX2700731	70A	31
AEX2800731	80A	31
AEX2900731	90A	31
AEX3100731	100A	31
AEX3125738	125A	38
AEX3150738	150A	38
AEX3175738	175A	38
AEX3200738	200A	38
AEX3250751	250A	51
AEX3300751	300A	51
AEX3350751	350A	51
AEX3400751	400A	51
AEX3500751	500A	51
AEX3600764	600A	64
AEX3700C64	700A	64
AEX3800C64	800A	64

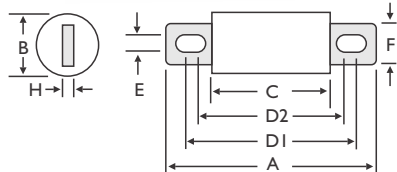

Voltage: 1000VDC **I.R.:** 50kA at 1000VDC
Time Constant: (L/R) 2 ± 0.5ms
Approvals: IEC 60269-4; UL 248-20

RELATED PRODUCTS:



Fixed Fuse Blocks
(see p.103)



Modular Fuse Blocks
(see p.104)

Series	Amperage	A	B	C	D1	D2	E	F	H
AEX...731	70A-100A	125	31	86	109	102	8.5	22	5
AEX...738	125A-200A	140	38	83	118	100	10.5	25	6
AEX...751	250A-500A	146	51	89	126	107	10.5	38	6
AEX...764	600A	196	64	88	162	122	13	50	10
AEX...C64	700A-800A	122	64	64	102	92.5	10.5	38	10