

# AUTO FUSE IN-LINE HOLDER



Part Number	Description
00341	Fuse holder with 1/4" QC 20A
00352	Fixing plate includes screw.

**Voltage:** 32V

**Body:** White PA 66

**Feature:** Gangable. Fuse holders interlock.

**Pack Size:** 1, 10, 100

**Notes:** Fuse is not included.

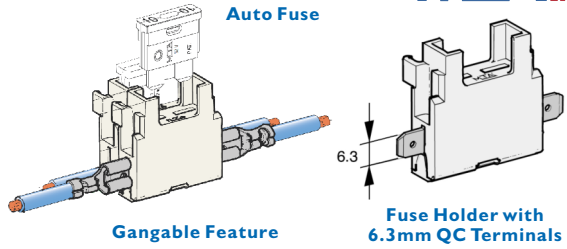

## RELATED PRODUCTS:



**Auto Fuse**  
(see p.17)



**LED Auto Fuse**  
(see p.17)



**Fuse Holder with Fuse and Fixing Plate**

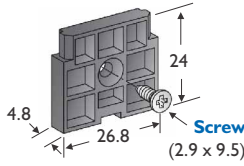

**Fixing Plate**

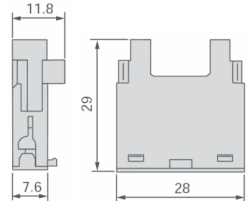

Dimensions in MM

# AUTO FUSE IN-LINE HOLDER (PANEL MT)



Part Number	Description
00330	Fuse holder with 1/4" Q.C 20A
00357	Secondary terminal lock (optional)

**Voltage:** 32V

**Body:** Black PA 66.

**Body Options:** Also available without terminals (#00331).

**Terminals 1/4" Q.C (Standard):** 1/4" 20A #07501BK

**Terminals Crimp Type (Optional):** See page 78.  
0.5 to 1.5mm<sup>2</sup> 14A, 2 to 3mm<sup>2</sup> 20A, 4 to 6mm<sup>2</sup> 37A.

**Fuse Holder Pack Size:** 1, 10, 100

**Secondary Lock Pack Size:** 250

**Notes:** Fuses & circuit breakers are not included.



**Fuse Holder with Auto Blade Fuse**

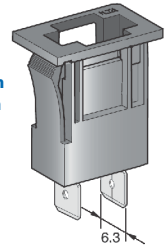

**1/4" Q.C Terminals**

**Snap In Design**

**Panel Mounting Dimensions (mm)**

a	b
21.9	0.8
22.0	1.0
22.1	1.5
22.2	2.0

**Mounting Hole**

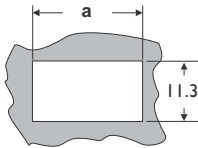

**Panel Thickness**

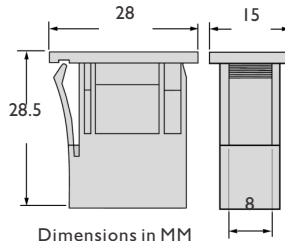

Dimensions in MM

## RELATED PRODUCTS:



**Auto Fuse**  
(see p.17)



**LED Auto Fuse**  
(see p.17)



**Auto Breaker**  
(see p.49)



**Secondary Terminal Lock (Optional)**



**1/4" QC Terminal (Standard)**



**Crimp Terminals (Optional)**



**Fuse Holder with Bladed Breaker**



Email: [info@prolecproducts.com.au](mailto:info@prolecproducts.com.au)  
Web: [www.prolecproducts.com.au](http://www.prolecproducts.com.au)