

JCASE FUSE IN-LINE HOLDER SPLASHPROOF



Features:

- Suit either Low Profile JCASE™ fuses (LJC) or standard JCASE fuses (JTF).
- They offer size and weight savings compared to MAXI™ fuse holders.
- Include a protective cover for splash resistance.
- Fuse links are compact and incorporate a design advantage over blade fuses. Over time the spring clips that hold blade fuses will weaken. In cartridge fuses, the weaker female part is designed into the disposable fuse so that the grip and electrical connection will never weaken.

IP67
58V

Part Number	Description
FHJC1002	Fuse holder with black cover

Rating: 60A
Voltage: 58VDC
Wire Thickness: #8AWG
Cable Insulation: GXL, 125°C
Operating Temperature Range: -40°C to +125°C
Max Fuse Insertion Force: 49 Nm
Pack Size: 1, 10, 50, 100, 250
Approvals: RoHS

RELATED PRODUCTS:



Low Profile Jcase
(see page 20)



Jcase
(see page 21)

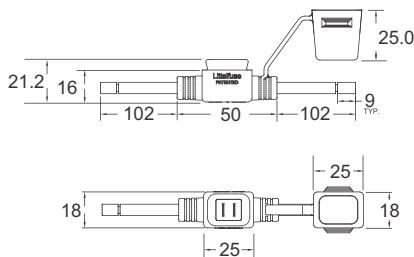

Dimensions in MM

MIDI FUSE IN-LINE HOLDER WITH COVER



58V

Features:

- Designed for use with bolt-down Midi fuses.
- May be installed directly inline with the cables with no mounting required.
- Can be used with heat shrink tubing for applications requiring more splash resistance. The curved design of the cover aids in prevention of tube-splitting during application.

Part Number	Description
04980921 GXM5	Fuse holder with black cover

Rating Continuous: 150A, **Rating Max:** 200A
Voltage: 58VDC
Operating Temperature Range: -40°C to +125°C
Max. Wire Size: 20mm²
Base/Cover Material: UL 94V-0 glass-filled nylon
Studs: Zinc plated steel M5 x 0.8
Stud Torque Rating: 5Nm
Hardware: Nylock Zinc-plated steel nuts (included).
Pack Size: 1, 10, 100
Notes: Midi fuse is not included.
Approvals: RoHS



Assembled Holder

RELATED PRODUCT:



Midi Fuse
(See page 24)

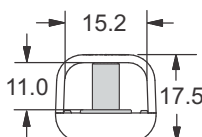

Side View

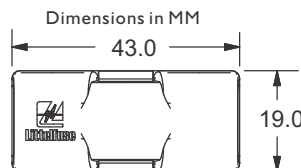

Top View

Dimensions in MM



Email: info@prolecproducts.com.au
 Web: www.prolecproducts.com.au