

CIRCUIT BREAKERS - SERIES 17 SMD DIAGONAL COMPACT



Main or supplementary circuit protection in industrial/commercial vehicles:

- Agricultural
- Buses
- Battery Chargers
- Construction
- Trucks
- Emergency Vehicles
- Marine
- Automotive Lifts
- Recreational Vehicles



Features:

- Compact base.
- Ignition protected and weatherproof.
- Superior moisture seal.
- Corrosion resistant studs & hardware.
- 1/4" Stainless steel studs.
- Robust thermoplastic case.
- Accommodates new *tripID*™

Protect:

- Wiring
- Lighting
- Motors
- Pumps
- Alternators
- Batteries
- Air Compressors
- Inverters
- Converters
- Generators

Manual Reset



Automatic (TI)

Part Number	Part Number	Ampere Rating
171-S8-020	175-S8-020-2-R	20A
171-S8-025	175-S8-025-2-R	25A
171-S8-030	175-S8-030-2-R	30A
171-S8-035	175-S8-035-2-R	35A
171-S8-040	175-S8-040-2-R	40A
171-S8-050	175-S8-050-2-R	50A
171-S8-060	175-S8-060-2-R	60A
171-S8-070	175-S8-070-2-R	70A
171-S8-080	175-S8-080-2-R	80A
171-S8-090	175-S8-090-2-R	90A
171-S8-100	175-S8-100-2-R	100A
171-S8-110	175-S8-110-2-R	110A
171-S8-120	175-S8-120-2-R	120A
171-S8-135	175-S8-135-2-R	135A
171-S8-150	175-S8-150-2-R	150A
171-S8-175	175-S8-175-2-R	175A
171-S8-200	175-S8-200-2-R	200A

Manual (TIII)

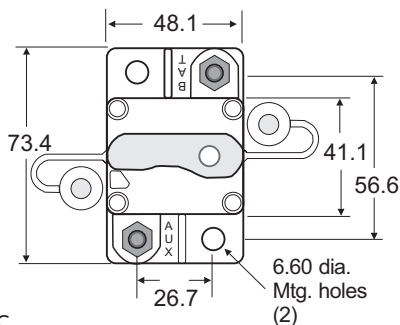

Voltage Ratings:

Type TI: (20A-200A): 30VDC.
 Type TIII: (20A-150A): 48VDC, (175A-200A): 30VDC.

I.R. Ratings:

Type TI (20A-150A): 3kA at 30VDC, (175A-200A): 1.5kA at 30VDC.
 Type TIII (20A-150A): 3kA at 14VDC, 1.5kA at 48VDC.
 Type TIII (175A-200A): 2.5kA at 14VDC, 1.5kA at 30VDC.

Ultimate Trip: Must hold 100% at 25°C.

Must trip at 135% within 1 hour.

Housing: UL94 V-0 rated black thermoplastic.

Termination: Diagonal 1/4" studs.

Terminal Hardware: Stainless steel sems nuts included.

Stud Insulator Caps: Included. Black colour.

Operating Temp: -40°C to 85°C.

Ingress Protection Rating: IP67

Manual Reset Indicator: Bright yellow mechanism provides visual

Indication of tripped condition on manual reset breakers (Type TIII).

Pack Size: Stock lines 1 pc, indent items 36 pcs.

Approvals: SAE J1625, J1171, ABYC E-11, MIL-STD-202, UL I077(UL)

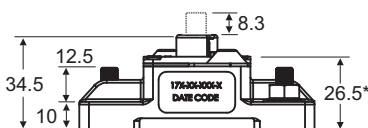

Dimensions in MM

RELATED PRODUCTS *tripID*™



Part Number: 17LED-R **Voltage:** 10-30VDC
tripID Surface mount accessory.
 Provides a red lit visual indication of an open circuit. Can be reused. Simply snap on and off as

Custom Button Options



Breaker with *tripID* **Recessed Button** **Button Guard**



Email: info@prolegproducts.com.au
 Web: www.prolegproducts.com.au