

## EV / HYBRID FUSES EFP 125V



### Features

- Ultra compact size and high power density.
- Operation as low as 300% of nominal current ( $I_n$ ) overload protection.



**NEW**



Part Number	Ampere Rating
EFP2500A01	50A
EFP2600A01	60A
EFP2800A01	80A
EFP3100A01	100A
EFP3150A01	150A
EFP3200A01	200A
EFP3250A01	250A
EFP3300A01	300A
EFP3350A01	350A

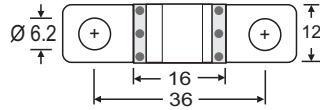
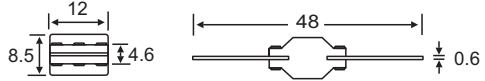

Dimensions in MM

**I.R. & Voltage:** 3kA (125VDC), 6kA (100VDC), 8kA (63VDC)

**I.R. Ratings To:**

**Designed To:** UL 248-13, ISO 20934-2019 (Type SF36)

**Approvals:** UL (File E485737)

## ESS FUSES EFT 150V



EFT series EV fuses are specially engineered and tested to provide best-in-class protection performance in protecting high power battery charging and managing systems of Electrical Vehicles and Hybrid Electrical Vehicles, up to 150Vdc in ratings from 100A to 500A.

### Features

- Ultra compact size and power density.
- High Breaking Capacity (HBC) 20kA.
- Ceramic body. Low watt losses.
- For short circuit protection.



**NEW**

Part Number	Ampere Rating
EFT3100AA0	100A
EFT3150AA0	150A
EFT3200AA0	200A
EFT3250AA0	250A
EFT3300AA0	300A
EFT3500AA0	350A
EFT3400AA0	400A
EFT3500AA0	500A



**I.R. & Voltage:** 150VDC, 3In - 20kA (100A to 350A)

**I.R. & Voltage:** 150VDC, 3In - 20kA (400A)

**I.R. & Voltage:** 125VDC, 3In - 20kA (500A)

**Body Material:** Ceramic

**Designed To:** UL248-13, ISO 20934-2019, IEC 60269-7

**Approvals:** UL: E485737 TUV: R50595443

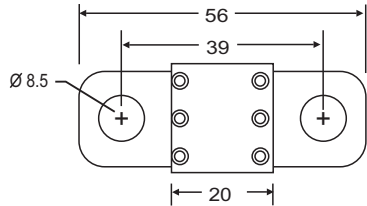

Dimensions in MM

### RELATED PRODUCTS:



**Modular Fuse Blocks**  
Short M8 Stud



**Modular Fuse Blocks**  
Tall 1/4" Stud